

Dimensions and construction of a
SCUBA REGULATOR
LOW-PRESSURE FEMALE PORT

The common USA scuba low-pressure
fitting is a standard
SAE J1926 O-ring hydraulic fitting

Machine this end for your desired
application, such as 1/4 NPT female
pipe thread for compressed air line.

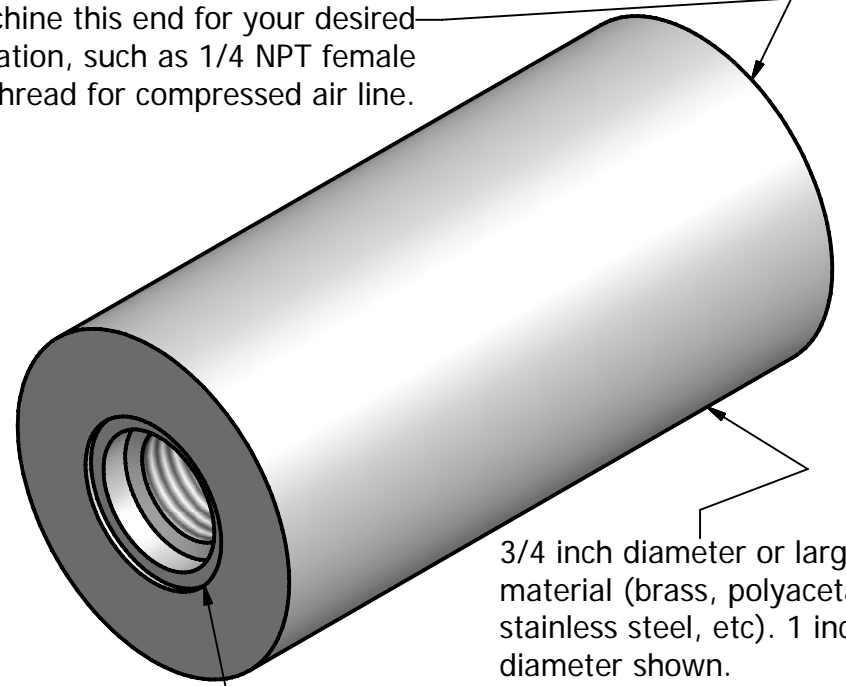

3/4 inch diameter or larger
material (brass, polyacetal,
stainless steel, etc). 1 inch
diameter shown.

Male low-pressure
scuba hose fits here

0.100
0.020

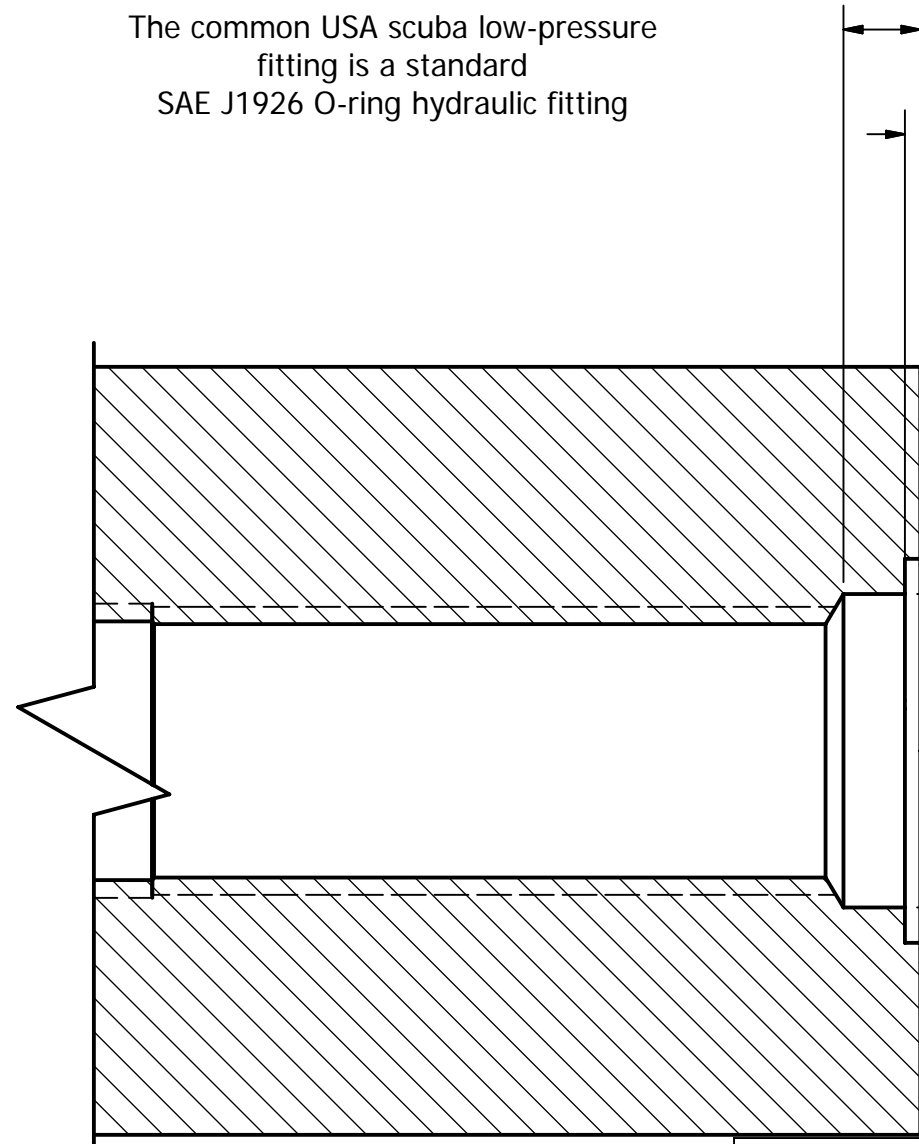

0.408
(Use
13/32"
drill)

0.500
(Use
1/2"
end
mill)

3/8-24 UNF - 2B

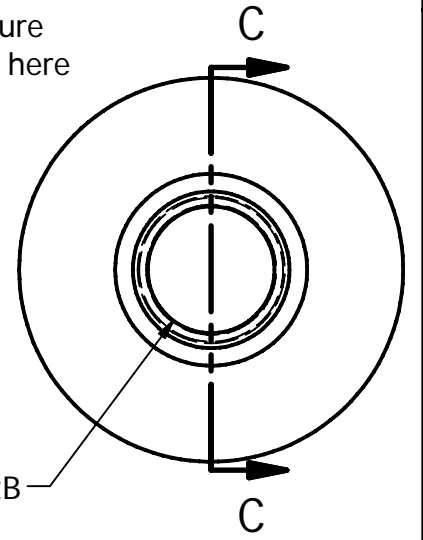

SECTION C-C
SCALE 4 : 1

Richard J Kinch, PhD -- Palm Beach County, Florida USA -- <http://www.truetex.com>
scuba_lp.idw